

Site Seeing

Lake Shore

California dreaming on the waterfront

30-storey tower overlooks lake

Wall of windows maximizes view

W.D. LIGHTHALL
SPECIAL TO THE STAR

Preview sales launch today for the Malibu at Harbourfront, a condo project described as bringing California-inspired design and life-style features to Toronto's waterfront.

Malibu is a 30-storey tower with an 11-storey podium at its base. The \$100-million project with 455 suites is planned for the northwest corner of Bathurst and Fleet Sts, just north of Lake Shore Blvd. W.

"The Malibu is about a modern, California style," Says Mark Reeve, of the Urban Capital Property Group, a consulting firm involved in the project.

Units will have open floor plans and floor-to-ceiling windows with views of the downtown and waterfront.

Design features that are light in colour with a spacious feel have been selected for both the suites and the common areas. The project includes the Malibu Club Spa, a three-storey rooftop centre with an indoor pool, saunas, exercise facilities, lounges and outdoor terraces overlooking Lake Ontario. The lobby, created by Toronto interior designer Mike Niven, reflects the California-style, boutique-hotel theme. A series of digital screens will show rolling ocean surf, and walls will be lined with backlit images of California beaches. "It's taking the big surf and pulling it into the lobby environment in a very cool and unorthodox way," Niven says. "Other elements are seating that looks as if it's carved out of driftwood, mixed with some very modern Italian furniture. We were looking to create an environment that

is hip and current while bringing in reminders of a beachfront life-style." All units in the tower will have at least one wall of floor-to-ceiling windows, and the building was designed with a curved exterior to provide views of the skyline, waterfront of both to as many units as possible. "The idea is that when you are in the suites, you have a sweeping, panoramic view in front of you," Reeve says. Units in the tower range from 348-square-foot studios to 879-square-foot two-bedroom units. Prices range from \$99,900 to about \$300,000. All units have a balcony, and top-floor penthouses will have terraces. The podium offers one- and two-storey beach lofts, ranging from 628 to 1,182 square feet for one-bedroom and one-bedroom-with-den units. Podium prices start at \$184,900. All units in the podium will have a balcony, and the two-storey suites will have a wall of windows 16 feet high. Parking spots (\$19,000) and storage lockers (\$4000) are extra. Maintenance fees for all suites are 39 cents per square foot, including hydro. Robert Hirsch, president of developer

Malibu Investments Inc., says one of the project's advantages is its location. "We are at Harbourfront, we are just a few steps from the lake and we are very close to King West and the entertainment district," he says. Units include movable islands in the kitchen, six appliances in black or white, and individual climate control. Pre-engineered hard wood floors are included in the purchase price as an opening special. Construction is expected to start next fall, with occupancy tentatively scheduled during the summer of 2006. Preview registrations begin today. Grand opening of the sales office and model suite is next Saturday. Office hours will be noon to 7 p.m. Monday to Thursday and noon to 5 p.m. weekends. To register, call 416-601-1881 or visit www.malibuharbourfront.com.

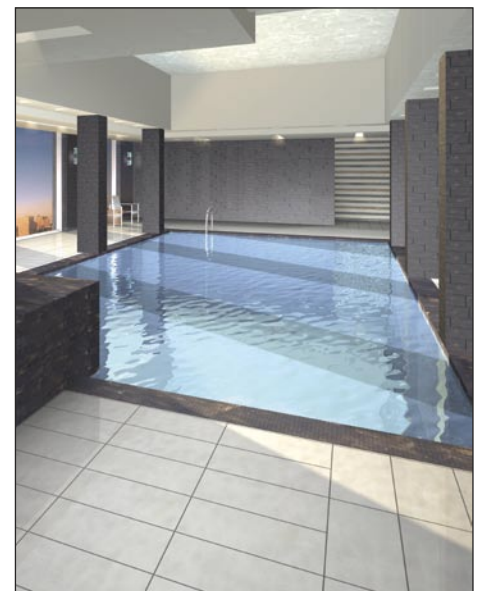

The Malibu Condominiums at Bathurst and Fleet Sts. will have a 30-storey tower with an 11-storey podium at its base. A three-storey rooftop club will include an indoor pool, saunas and outdoor terraces overlooking the lake.